

Flanged End Flush Diaphragm Seal

DS200 Series

Features

- Flanged end diaphragm processing type
- Standard to DIN 2501, ANSI B1.20, etc
- Applicable with most measuring instruments
- Double laser welding diaphragm design
- Wide range corrosive applications
- Various diaphragm materials selection
- Diaphragm or wetted parts coating or lining
- Pressure range -1..0,-1..+24 to 0.. 400 bar
- Various liquid filling supported

Special



*Double welded diaphragm



Technical Specification

- Model and pressure configuration
Pressure : 0.. 1 bar to 400 bar
Vacuum : -1.. 0 bar
Compound : -1..24 bar
- Diaphragm diameter
According to flange size and pressure range
-1 bar..0 : Ø59 mm
P < 25 bar : Ø52 mm
P > 40 bar : Ø36 mm
- Instrument Connection Size
Standard G 1/2" or 1/2" NPT
- Process Connection Size
Flanged end to DIN 2501, ASME B16.5, etc
DIN 2501 : DN25..125, PN 10..250
ASME B16.5 : 1"..4", Rating 150#..2500#
- Working temperature range
Working media -40°..+200°C
Please refer to filling selection table
- Optional Accessories
Stainless steel armoured capillary, max.15m
Cooling tower AR100, maximum temp.
Cooling tower AR200,
Cooling tower AR300,

Material

- Diaphragm seal Body
SS 316 (Standard) or * SS316L
- Diaphragm
SS 316L (Standard),
* Optional material
Titanium,
Monel,
Hastelloy,
Tantalum, or other exotic materials
- Diaphragm filling
Standard Silicone oil

Dimension (mm)

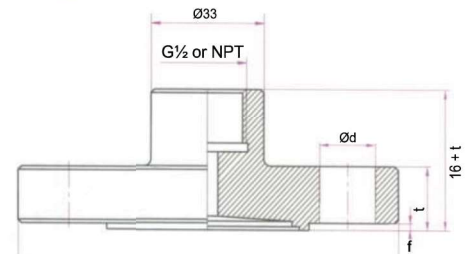

*Dimension size please refer to flange table

DS 200 Series

Diaphragm filling reference

Working Fluid	Working Temp.	Specific Gravity	Service
Silicone oil Std	-40°..+130°C	0.94 g/cm2	General industry
Silicone oil DC2	-30°..+200°C	1.07 g/cm2	High temperature
Fluorocarbon oil	-30°..+160°C	1.93 g/cm2	H2, O2, salt, acid
Glycerine	-5°..+ 70°C	1.27 g/cm2	Food, sanitary
Vegetable oil	-5°..+100°C	0.93 g/cm2	Food, sanitary

Flange Facing

Standard	Flange Facing
ISO PN 10..40	Raised Face (RF), Flat Face (FF), Male tongue, Female groove, M/F spigot
DIN PN 20..420	Raised Face (RF) - RF de 1.6/6.4, Male tongue - Large/Small, Female groove
ASME Class 150..2500	Ring Type Joint (RTJ), Female spigot - Large/Small, Male spigot - Large/Small

Ordering Code



DS200 - Diaphragm^① - Flange Size^② - Filling^③ *Option^④

①	Diaphragm Material
SS	SS 316 L
TI	Titanium
TA	Tantalum
HC	Hastelloy (H276C)
MO	Monel (Cu30Ni70)
XX	Other material

②	Flange Size and Rating
	Please refer to flange size and rating table

③	Diaphragm Filling
A	Standard silicone oil -40°..+130°C
B	Hi-temp. silicone oil -30°..+200°C
C	Fluorocarbon oil -30°..+160°C
D	Glycerine -5°..+ 70°C
E	Vegetable oil -5°..+100°C

④	Option
OM	Other upper / lower body material
AC	Capillary (Meter), eg. AC5 -5 meters
DC	PTFE diaphragm coating
DH	Halar coating
DF	PTFE diaphragm foil
DW	PTFE wetted parts coating
X1	Cooling tower, AR100
X2	Cooling tower, AR200
X3	Cooling tower, AR300

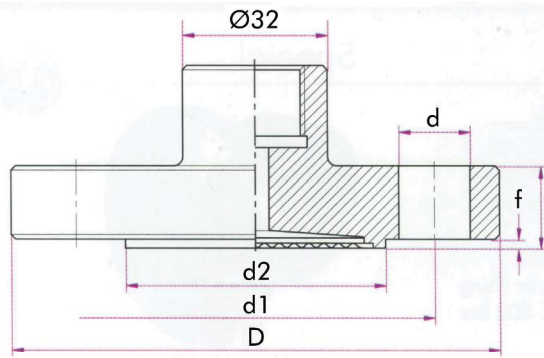

- Process flanged according to ASME B16.5 Standard



Size	Class	D	t	f	d1	d2	d	
							Pcs	Size
1"	150	108.0	14.2	1.6	79.2	50.8	4	15.7
1¼"	150	117.3	15.7	1.6	88.9	63.5	4	15.7
1½"	150	127.0	17.5	1.6	98.6	73.2	4	15.7
2"	150	108.0	19.1	1.6	120.7	91.9	4	19.7
3"	150	108.0	23.9	1.6	152.4	127.0	4	19.7
4"	150	228.6	23.9	1.6	190.5	157.2	8	19.7
1"	300	124.0	17.5	1.6	88.9	50.8	8	19.7
1¼"	300	133.4	19.1	1.6	98.6	63.5	4	19.7
1½"	300	155.4	20.6	1.6	114.3	73.2	4	22.4
2"	300	165.1	22.4	1.6	127.0	91.9	8	19.1
3"	300	209.5	28.4	1.6	168.1	127.0	8	22.4
4"	300	254.0	31.8	1.6	200.2	157.2	8	22.4
1"	600	124.0	17.5	6.3	88.9	50.8	4	19.1
1¼"	600	133.4	20.6	6.3	98.6	63.5	4	19.1
1½"	600	155.4	22.4	6.3	114.3	73.2	4	22.4
2"	600	165.1	25.4	6.3	127.0	91.9	8	19.1
3"	600	209.6	31.8	6.3	168.1	127.0	8	22.4
4"	600	273.1	38.1	6.3	215.9	157.2	8	25.4

* Available Class 900.. 1500. Please consult with us...

- Process flanged according to EN 1092-1, from B1 / DIN 2501 Standard, form D



DN	PN (Bar)	D	t	f	d1	d2	d	
							Pcs	Size
25	10.. 40	115	22	2	85	68	4	14
	63.. 40	140	24	2	100	68	4	18
40	10.. 40	150	18	2	110	88	4	18
	63.. 40	170	26	2	125	88	4	22
	160	170	28	2	125	88	4	22
50	250	185	34	2	135	88	4	26
	10.. 40	165	20	2	125	102	4	18
	63	180	26	2	135	102	4	22
	100	195	28	2	145	102	4	26
	160	195	30	2	145	102	4	26
80	250	200	38	2	150	102	8	26
	10.. 16	200	20	2	160	138	8	18
	25.. 40	200	24	2	160	138	8	18
	63	215	28	2	170	138	8	22
	100	230	32	2	180	138	8	26
100	160	230	36	2	180	138	8	26
	250	255	46	2	200	138	8	30
	10.. 60	220	20	2	180	158	8	18
	25.. 40	235	24	2	190	162	8	22
	63	250	30	2	200	162	8	26
	100	265	36	2	210	162	8	30
160	265	40	2	210	162	8	30	
	250	300	54	2	235	162	8	33

* Available face finishing in Raised Face (RF), Flat Face (FF), Ring Type Joint (RTJ), etc. Please consult with us....